



HMW230 8_2021

The Hygienius MediWash Installation and operating instructions



*Please note: the soap
and towel dispensers
are not included*

Manufactured by:
Teal Patents Limited
Unit 2, Waterloo Avenue
Chelmsley Wood Industrial Estate
Birmingham B37 6QQ
Telephone: 0121 770 0593
Email: enquiries@tealwash.com
www.tealwash.com



Please note: the soap and towel dispensers are not included

The Hygienius MediWash

Installation and operating instructions

Index

Important safety instructions	page 4
Box contents	page 5
Parts identification	page 6
Installation	page 8
Operating instructions	page 9
Cleaning instructions	page 10
Troubleshooting guide	page 10
Guarantee	page 11
Disposal	page 11
Technical specification	page 12

IMPORTANT SAFETY INSTRUCTIONS



This sink
for hand wash
only

Before using this appliance, read all instructions and familiarise yourself with the operation of the unit

1. This appliance can be used by children aged from eight (8) years and above, persons with reduced physical, sensory or mental capabilities, or persons with lack of experience and knowledge only if they have been given supervision or instruction concerning use of the appliance in a safe way and understand the hazards involved. Cleaning and user maintenance shall not be made by children without supervision.
2. Children should be supervised to ensure that they do not play with the appliance.
3. The unit should only be used in accordance with these instructions. Do not carry out any maintenance other than is shown in these instructions or as advised by Teal Patents service support.
4. Do not place in a hot area of more than 70°C.
5. Do not handle the plug with wet hands.
6. Do not use with a damaged cable or plug. If the supply cable is damaged, it must be replaced by the manufacturer, its service agent or similarly qualified persons, in order to avoid a hazard.
7. If the appliance is not working as it should, has been dropped, damaged or submerged in water do not use. Contact the seller or Teal Patents.
8. Do not dismantle the unit or attempt to repair the unit: this will invalidate the warranty.
9. This equipment is for heating water for handwashing only. It is not designed for washing of crockery or other items.
10. Water dispensed is not suitable for drinking.
11. Water is dispensed at a temperature of 38-40°C.
12. The appliance must be connected to a mains supply rated at 220 to 240V AC.

13. The unit must be protected by a fuse rated at 13 amps.
14. If used outdoors the equipment should be protected by an RCD.
13. Cable should be placed in such a way to avoid trip hazards.
15. Do not stretch the cable and beware of sharp corners which may damage the cable.
16. Unit is for placement on a level, flat floor only. Lock the front castors in place before use.
17. Unit should be positioned where it does not obstruct walkways or access to services.
18. Unit must only be filled with clean cold water.
19. Do not overfill, only fill to just below the white filler cap.
20. The unit should not be operated without water.
21. Waste water is removed by lifting out the TEALtainer water carrier and pouring all waste water (red cap) into a foul drain.
22. This unit must not be subjected to a high pressure water jet.
23. Any spillages should be cleaned-up as soon as possible to avoid slipping hazards.
24. Keep unit away from direct heat sources.
25. Unit should not be left switched on when the building is unoccupied.
26. Do not alter the unit in any way this will invalidate the warranty and may make it unsafe to operate.

Box contents

Before installing the unit check that all parts are present and undamaged.

In the event of any shortages or damaged items contact the retailer.

Do not attempt to use substitute parts except as stated in these instructions.

Contents consist of:

- 1 MediWash hand washing unit with pre-fitted mains cable
- 2 TEALtainer water carriers with carrying handle
- *Please note: The MediWash is intended for use with the soap and hand towel dispenser of the user's choice. They are not provided with the MediWash.*

Parts identification

Paper tower dispenser (not supplied)

Soap dispenser (not supplied)

Video handwashing instructions

Tap and automatic sensor

Disclaimer

Teal Patents Ltd has a policy of continual improvement in product quality and design.

The company reserves the right to change the specification of its models at any time.

4 castors - front ones are lockable

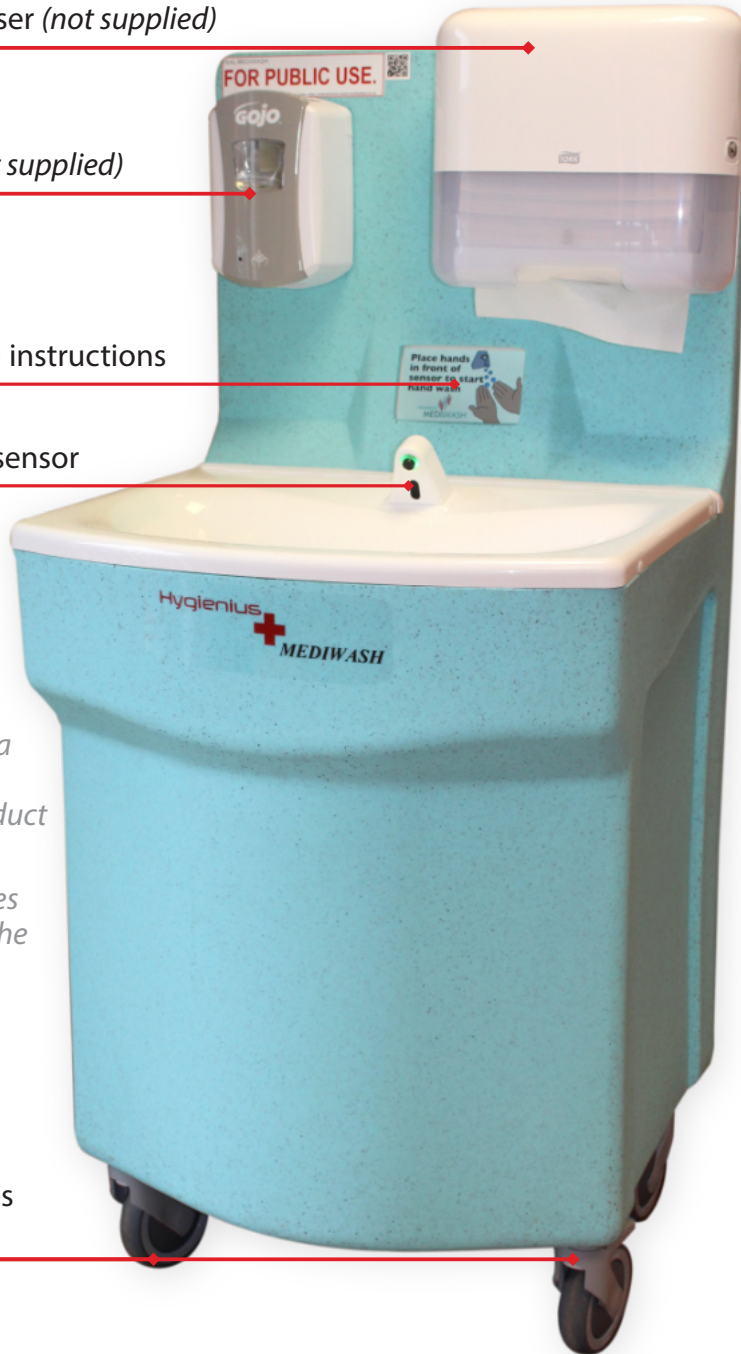

Rear of MediWash

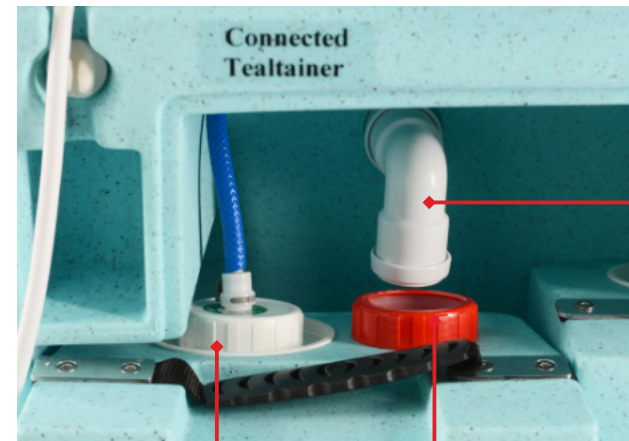

Waste water pipe

White cap - clean water

Red cap - Dirty water

Blue purge button

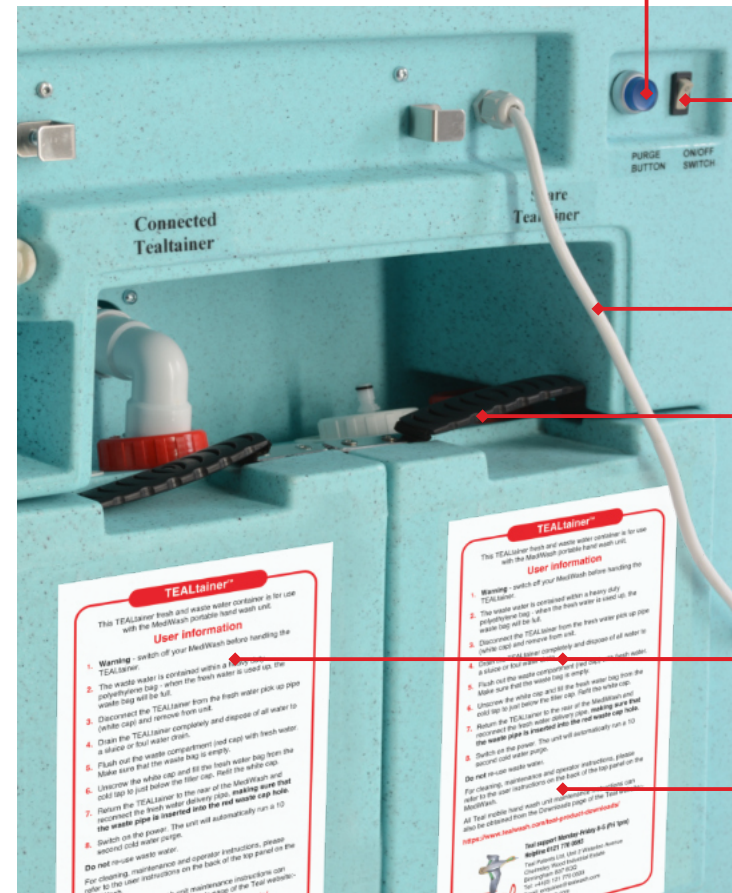

On/Off switch

Power cable

TEAltainer carrying handle

TEAltainer water containers

TEAltainer user instructions

Installation

FAILURE TO FOLLOW THESE INSTRUCTIONS MAY INVALIDATE YOUR WARRANTY.

The MediWash Free Standing Mobile Handwash Unit

This unit has been designed to be floor standing only and must be positioned on any firm, flat, level surface.

The MediWash should be positioned where it does not obstruct walkways or access to services.

Fasten the front lockable castors to hold the MediWash in place when in the desired location.

The cable should be positioned in such a way to avoid trip hazards. Do not stretch the cable and beware of sharp corners which may damage the cable.

Ensure that the position of the unit allows sufficient space for the removal of the TEALtainer water container when it needs to be emptied and refilled.

Check that the unit is upright and level before filling.

Failure to follow these instructions may result in personal injury, damage to the product or damage to property.

Electrical Connection

This unit must be connected to a mains power supply using the plug provided.

Do not attempt to replace the plug or hard wire the unit unless you are competent electrician.

If used outdoors the equipment should be protected by an RCD.

Waste Water

All MediWash models come complete with two TEALtainer water containers.

Clean fresh tap water should be added via the white cap.

Dirty water is drained via the red cap.

The MediWash can be kept operational by swapping over the TEALtainer water containers when one becomes full. Switch off the ON/OFF switch located at the back of the unit, disconnect the water delivery pipe from the white cap by pushing the grey tab whilst pulling upwards, and remove the TEALtainer.

Position the replacement TEALtainer in the unit and feed the waste pipe back into the red waste cap hole, connect up the water delivery pipe and switch on.

Operating instructions

Getting Started

Your MediWash provides a hot water hand wash without the need for external plumbing or drainage. It is entirely self contained, with each TEALtainer water container holding 9 litres of fresh water.

The waste water is contained within a heavy duty polyethylene bag - when the fresh is used up the waste bag will be full.

The MediWash provides up to 40 wet/soap/rinse cycles per filling of each of the TEALtainers.

Please note:- the MediWash has nothing to adjust. Both the water temperature (approx. 38 - 40°C) and the wet/soap/rinse cycles are factory set.

Unpacking

Check that the component parts and specification are correct. Check for damage and retain packaging. Notify Teal immediately if damage is found.

Setup

Disconnect the water delivery pipe from the white cap by pushing the grey tab whilst pulling upwards and remove the TEALtainer.

Fill with cold water through the large opening to just below the base of the white cap. Return the TEALtainer to the unit and feed the waste pipe back into the red waste cap hole and connect up the water delivery pipe.

Connect the 13 amp plug into the 230V mains socket and switch the unit on by means of the ON/OFF switch located at the back of the unit.

The automatic sensor will light up and the unit will run a 10 second cold water purge. The MediWash is now ready for use.

Operation

Follow the instructions on the video screen. To operate, place your hands in the bowl by the sensor and the automatic sensor will start to flash, beginning the wash/rinse cycle. Water will be dispensed for 3 seconds to enable hands to be wetted.

Apply soap and lather thoroughly as per the on-screen instructions, which will show a 20 seconds countdown. At the end of that period, warm water will be dispensed for 10 seconds to enable soap to be washed off the hands.

Remove hands from the bowl and dry with a paper towel. The MediWash will automatically reset ready for the next user.

Cleaning instructions

Empty the TEALtainer to a foul water drain and rinse with clean water.

If unit is left unused for an extended period it is recommended that it is emptied of water and replenished with fresh water.

Clean all surfaces with an anti-bacterial wipe or disinfectant paying particular attention to frequent contact points.

Do not use abrasive cleaners which may scratch the external surfaces.

This unit must not be subjected to a high pressure water jet.

It is recommended that your MediWash is disinfected every 48 hours. Fill the fresh water compartment, add **500ppm chlorate solution** and switch on. After the automatic 10 second purge, press the purge button. The unit will run for 5 minutes effectively disinfecting the complete system. Dispose of all the water and then flush through with clean water.

Troubleshooting guide

Problem: the unit will not work and the sensor does not illuminate

- Check that the appliance is plugged into and switched on to a mains supply that corresponds to the rating plate at the rear of the unit.
- Check that the unit itself is switched on. Locate the on/off switch on the back of the unit. The sensor will illuminate and the automatic purge will start.
- Check the fuse in the plug (use only a 13 Amp fuse to BS1362).

Problem: the unit seems to be working but there is a reduced/no water flow?

- Activate the off switch on the back of the unit, unclip and remove the TEALtainer (water container). Disconnect the pickup pipe by pushing the grey tab whilst pulling upwards.
- If the waste bag is fully inflated, empty it into a sluice or foul water drain. Withdraw the fresh water pickup pipe and check the filter for obstructions. New bags and filters are available from Teal.
- Ensure that the fresh water compartment is filled with cold clean water to just below the bottom of the white cap. Take care when handling the full container. Locate the TEALtainer into the unit.
- Ensure that the pickup pipe connector snaps on to the white spout and that the waste water pipe is properly positioned.
- Switch on the unit: it will perform a 10 second cold water purge to prime the system.
- If water still does not flow, check the tap nozzle for blockages. Clean with a pin or carefully lever out and contact Teal for a replacement.

Guarantee

All Teal Patents products are tested before leaving the factory.

The unit is covered by a two year return to manufacturer warranty from date of purchase – please ensure that you retain proof of purchase.

Any faulty items will be repaired or replaced, and the repairs guaranteed for the remainder of the original warranty period.

Should a unit need repair, those repairs only will be covered by a further 12 months warranty.

Exclusions

Teal Patents will not be liable to repair or replace goods where:

- The fault has been caused through misuse, accidental damage, use contrary to the manufacturers instructions, damage in transit or power surges.
- The appliance has been used on a voltage supply other than that specified on the product
- Repairs have been attempted by someone other than Teal Patents or an authorised dealer
- The appliance is second hand
- The warranty does not cover any claims for consequential loss or damage.

This guarantee does not affect your statutory rights as a consumer.

Disposal

At the end of its useful life, the handwash unit should not be disposed of in general household waste.

Units should be taken to a recycling facility for electrical and electronic items.

Please see WEEE regulations.



The Hygienius MediWash



Please note: the soap and towel dispensers are not included

Technical specification

Product Specification:

Overall height	1370mm
Height to bowl	880mm
Width	620mm
Weight (dry)	30.8kg

Electrical Specification:

Operating voltage	230V~50Hz/60Hz
Heater output	2 kW
Operating current	9A
IP rated	IP34

Conforms to EN61000-6-1 & EN61000-6-3.



Teal Patents Ltd

Unit 2, Waterloo Avenue
Chelmsley Wood Industrial Estate
Chelmsley Wood
Birmingham, B37 6QQ, UK
Tel: +44 (0) 121 770 0593
www.tealwash.com
Email: enquiries@tealwash.com